

THE RSK SHELTER ROOF FRAME

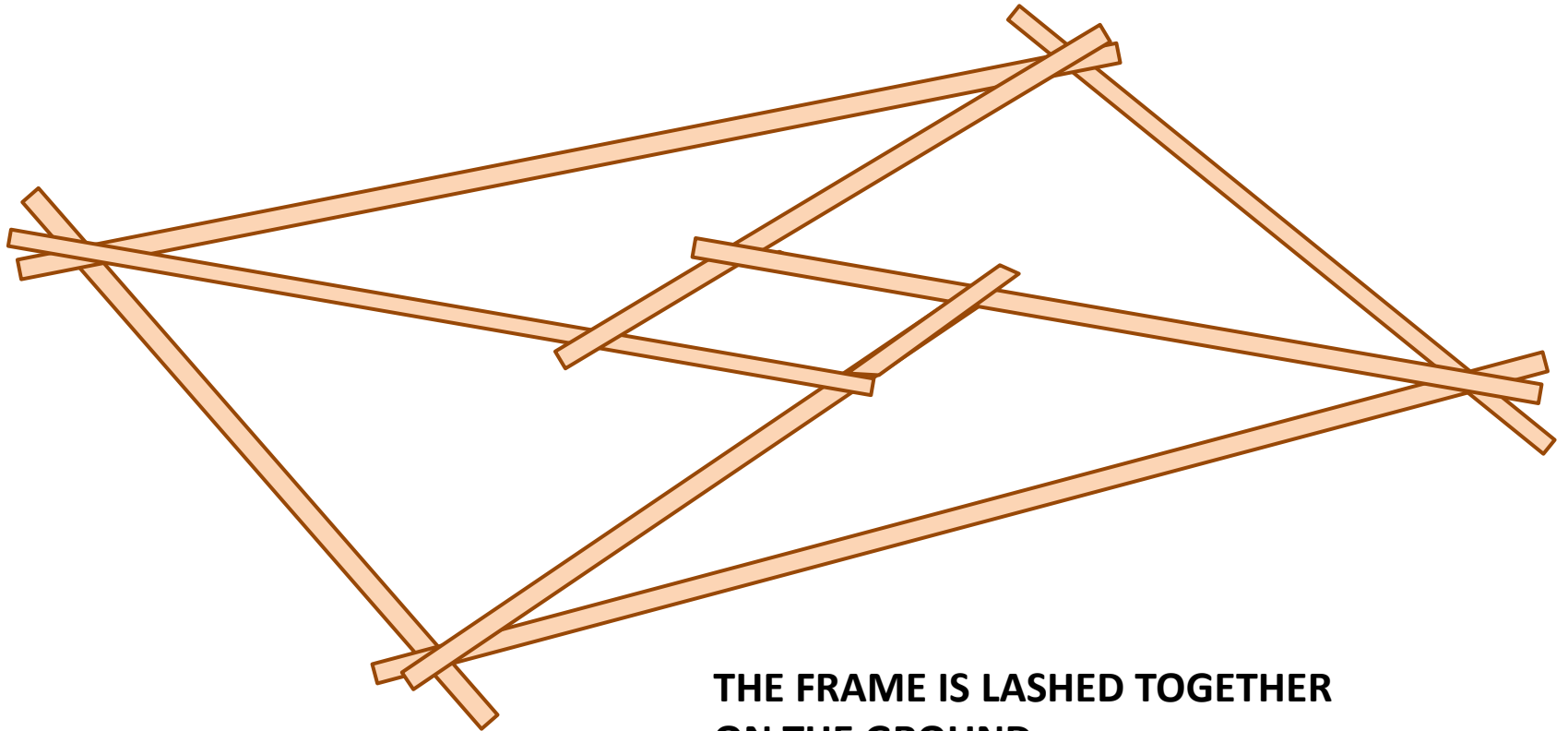

**THE FRAME IS LASHED TOGETHER
ON THE GROUND**

STRONG AND EFFICIENT

**TRADITIONAL METHODS ARE THEN
USED TO SUPPORT THE ROOF
FRAMES**

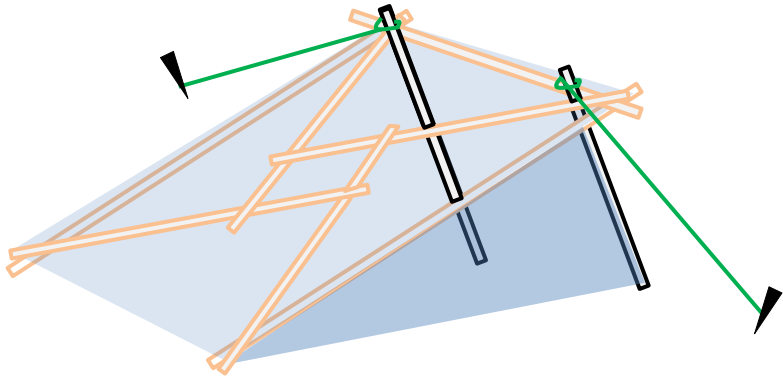

TWO PROPS FOR THE EMERGENCY RSK

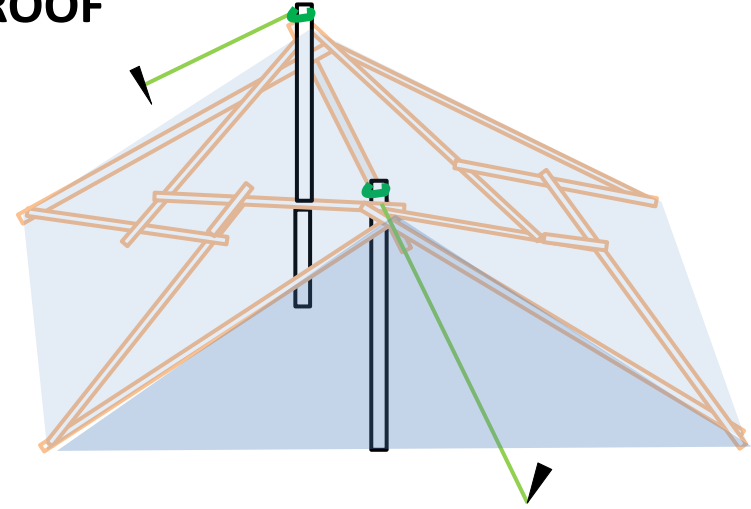

TWO PROPS FOR THE DOUBLE RSK

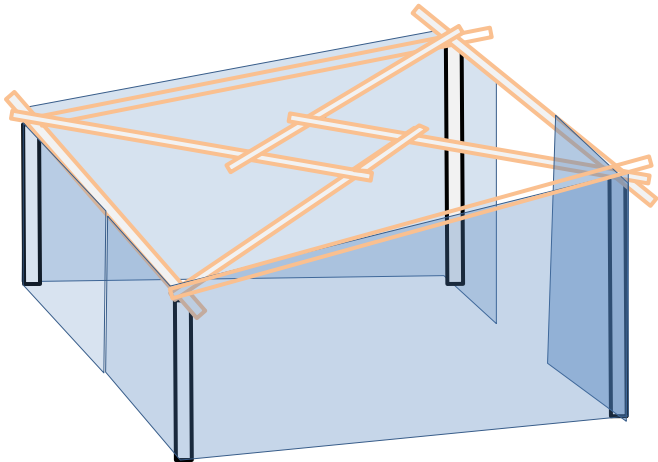

FOUR POSTS FOR THE STANDARD RSK

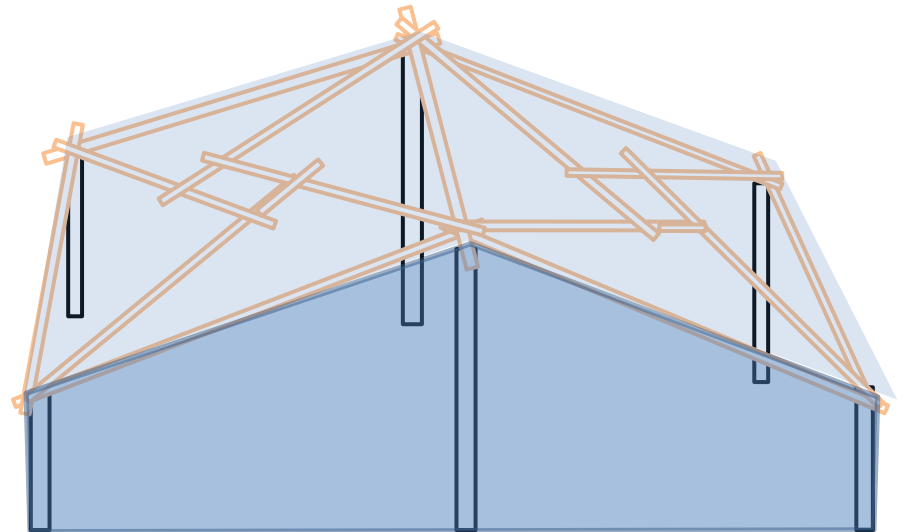

SIX POSTS FOR THE DOUBLE ELEVATED RSK